



5800 SPORT YACHT | A WHOLE NEW GENERATION



RIVIERA

A RIVIERA LIKE NONE BEFORE

It is a luxury boat beyond anything previously developed by Riviera, Australia's most awarded luxury boat builder.

The exciting new Riviera 5800 Sport Yacht, to be launched in early 2009, is the latest and most dramatic of the company's European-style Sport Yacht series.

The Riviera 5800 Sport Yacht takes luxury boating to a new level with a four-cabin, three bathroom layout (plus an optional crew cabin) including full beam master stateroom with midships king size double bed, the option of a galley in the saloon or below decks, an expansive cockpit with large dining table and a garage that can accommodate a 3.2-metre tender.

The design further expands the indoor-outdoor character and sense of light and space introduced on the first award-winning Riviera 3600 Sport Yacht and carried on to the 4700SY and 4400SY. The greater volume has allowed designers to take both exterior lines and internal design to a new level of sophistication to create even more visual appeal.

Fixed and opening portlights in the hull are a striking feature that add natural light and ventilation into the full beam master stateroom.

Designed utilising state-of-the-art 3D CAD software, the boat employs a range of new technologies, including revolutionary Volvo Penta IPS propulsion, an integrated system of marine diesel engines and steerable drive units mounted under the hull with twin counter rotating, forward facing, propellers. This system offers easy handling and manoeuvring even in tight situations and a joystick for easy docking. Volvo Penta IPS also offers up to 30 percent better fuel consumption than traditional shaft drive systems. Three Volvo Penta IPS 600 diesels rated at 435hp each are standard.

The Riviera 5800 Sport Yacht is equipped with a cutting edge digital switching system. You can control any DC circuit from either of two easy-to-use control panels at the helm and in the electrical control centre in the saloon. You no longer need to decide which circuit breakers to turn on; simply select the mode which best suits the operation of the vessel (cruise or entertain, for example) and the appropriate circuits will be energised.

The hull has been constructed utilising infusion moulding technology rather than the traditional open moulded lay-up of fibreglass and resin. The resin is introduced to the hull mould via an injection system and drawn through the glass fibre layers using vacuum suction, resulting in consistent hull thickness, reduced hull weight and improved glass fibre to resin ratio, providing greater strength.





LIGHT, SPACE – AND STYLE

With accommodation options of three or four cabins plus optional crew's quarters, the Riviera 5800 Sport Yacht is designed for comfort, whether overnighting in a sheltered bay or on a long-distance coastal cruise.

The cockpit is both spacious and functional with a wide lounge and table mounted on electric high/low pedestals. Wet bars, including solid surface tops with sink and mixer tap, are built into the port and starboard forward quarters of the cockpit. The starboard wet bar features a stainless steel ice-maker.

Forward, a sun pad with rails and drink holders is fitted to the foredeck. Under and behind the cockpit, a garage can house a 3.2-metre tender. A hydraulic swim platform lifter is fitted for ease of launching and retrieving the tender or PWC.

Interior space in the 5800 Sport Yacht feels very light, airy and spacious. The outdoors come inside as the window and door in the aft bulkhead open out and a huge electric sunroof slides open at the push of a button.

Stepping inside the saloon, the standard layout includes a large U-shape galley in the aft starboard quarter. The fully equipped galley is designed with a breakfast servery and two stools forward, immediately aft of the helm position.

The galley layout features quality appliances throughout, including an electric induction three-element cooktop, two drawer fridges and two drawer freezers, a convection microwave oven, solid-surface benchtop with a stainless steel underslung sink and mixer tap. The U-shape dinette, with soft leather seating for up to six adults and timber table is set on a raised platform forward to port. A liquor cabinet is set opposite the galley while the entertainment system includes an electric lift 40-inch LCD TV integrated with a Bose Lifestyle system.

The helm console is ergonomically designed so that all critical navigation equipment and controls are within easy reach. A high quality timber sports steering wheel completes the helm. Stepping down from the saloon, the companionway leads to the VIP guest stateroom forward and twin cabins on port and starboard sides.

The master stateroom aft features a king-size walk-around double bed amidships and striking deep windows on either side flooding the cabin with light. A deep walk-in wardrobe, and vanity table are built into the starboard side, with en suite bathroom to port.

The VIP guest stateroom forward features a queen island double bed with hanging lockers port and starboard.

The starboard twin cabin can quickly and easily be converted to a double simply by sliding the inner bed across. The port cabin features two bunks.

This cabin is replaced by the galley in the below deck galley layout option. A third bathroom is available to serve the twin cabins and act as a bathroom for day guests.









Riviera 5800 Preliminary Specifications

Length Overall (inc. swim platform & bow roller)	19.20 metres	63' 0"
Hull Length (Lh to ISO8666*)	17.60 metres	57' 7"
Beam (inc. gunwale)	5.38 metres	17' 6"
Maximum Draft (inc. props)	1.28 metres	4' 2"
Fuel Capacity***	2,650 litres	700 US gal.
Water Capacity***	750 litres	198 US gal.
Holding Tank Capacity***	272 litres	73 US gal.
Standard Engine x 3 Volvo	320.0 kW	435 hp each
Generator Onan EQD	22.5 kW	

The Riviera Group Warranty

Riviera warrants to the first retail purchaser during the periods herein that it will, subject to the terms and conditions in the full Riviera Group Warranty, replace or repair, at its option, defects caused by faulty workmanship or materials under normal use and service during the first twelve (12) months and (5) years for hull structure. Please refer to your Riviera Owner's Manual and your Riviera Dealer for full details of the comprehensive Warranty.

Due to The Riviera Group's commitment to continually improve our products, we reserve the right to modify or change, without notice, any materials, specifications, equipment and/or accessories. All measurements quoted are approximate and pictures and drawings displayed are indicative only.

Riviera is the owner of the copyright material (including the photographic material) contained in this brochure and any reproduction of any part thereof without the express licence of Riviera may infringe this right.

The Riviera Group Clarification of Specification

* Length of the hull (Lh) to ISO8666: Includes all structural and integral parts. (ie. the moulded length of the hull). It excludes parts that can be removed in a non-destructive manner without affecting the structural integrity of the craft, eg. pulpits, outdrives, diving platforms, rubbing strakes.

** Dry weight represents the estimated minimum weight of a boat with standard engines and options, no fuel or water on board, no equipment or provisions and no personnel. The stated dry weight may be exceeded.

*** Denotes nett tank capacity. For usable capacity do not rely on more than 90% of tank capacity. Actual usable capacity will vary according to boat trim and sea state.

Speeds are subject to normal weather conditions, fuel and/or water levels, passengers and equipment loads.

Refer to your Riviera Owner's Manual and your Dealer for height to hardtop and maximum height details.

The specifications in this document are not complete or definitive and are subject to change without notice and therefore may not be current. Riviera will not be liable (in contract, tort or otherwise) for any loss resulting from the inaccuracy of any information contained in this document.

Specifications may vary on a regional basis. Some images in this brochure may include non-standard or after-market options.

Warnings

The Riviera Group is committed to building the best luxury cruisers, tailored to suit specific countries and their individual compliance laws and regulations. Riviera equipment and build specifications approved for one country may not be compliant with another country's safety and equipment regulations and as such those cruisers may have no recourse to The Riviera Group's extensive manufacturer's warranties.

Each country and State has different safety equipment standards. It is important that you ensure the requirements in your jurisdiction are met prior to the vessel being used.

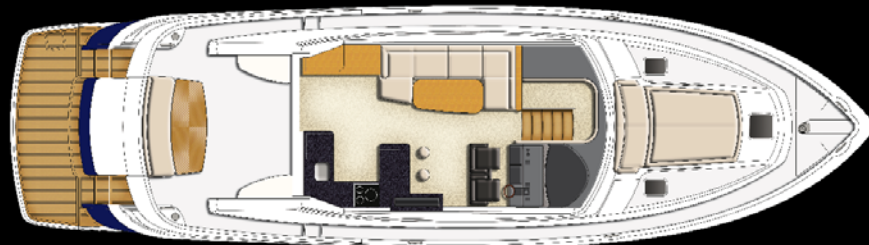
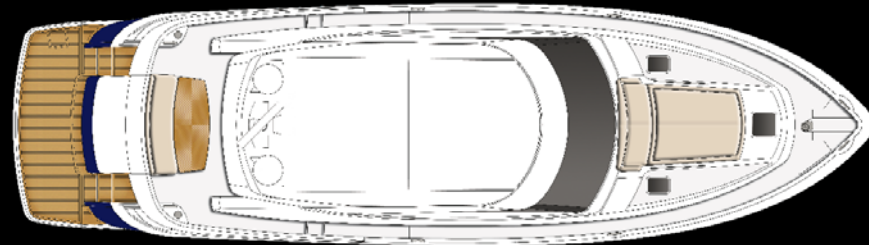
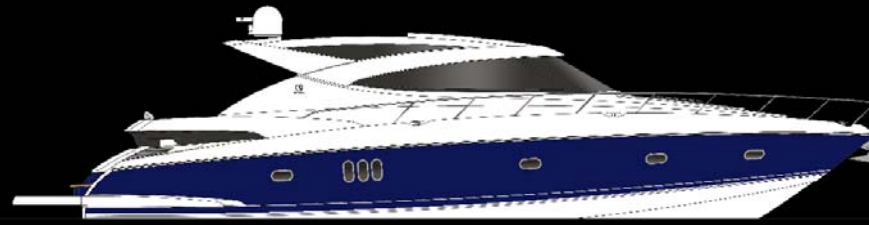

Standard Layout



Standard Layout

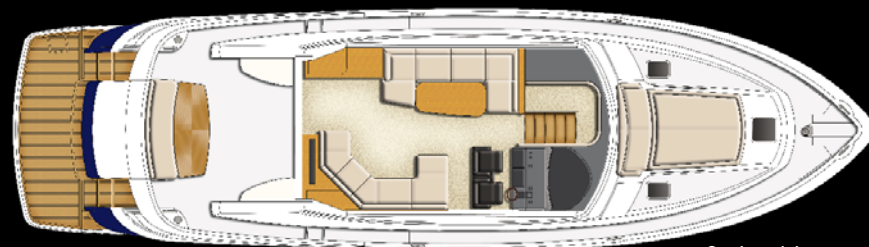

Optional Layout



Optional Layout



RIVIERA

www.riviera.com.au