



5000 SPORT YACHT WITH ZEUS POD DRIVES | THE ULTIMATE ENTERTAINER



PUTTING MORE LIFE INTO YOUR LIFESTYLE

The inspiration for our Sport Yacht series, came from recognising the changing values and lifestyles not just of boat owners, but people everywhere – changes that are reflected in such domains as contemporary architecture, interior design and the styling of prestige cars.

Although luxury is as desirable as ever, the trend globally is towards less formality. In so many areas of life, easy living and convenience have taken the place of stuffy traditions, unnecessary embellishments and sometimes ostentatious and impractical features.

Such was the thinking behind the design of our 5000 Sport Yacht. The clean lines, the bright, contemporary interior, the modern materials, the emphasis on easy entertaining, the solid feel and handling together with the spirited performance are among the many qualities that made this one of our most successful model ever.

The flow between the cockpit and the saloon that so many find so refreshing is inspiring on this 50' model. It brings the inside outside like never before – and the saloon is brighter and lighter than ever. The ease with which you can cater to a large party and the standard of comfort your guests can enjoy is magnificent.

Australians are masters of informal entertaining. For us it is all very relaxed, even though our catering is often lavish and of superb quality – so it is only fitting that it should be a vessel with an Australian heritage that brings these principles to life on the water.



1. Wide side decks with generous handrails make docking and moving forward safe and easy. 2. The expansive cockpit features an aft lounge that runs the full width of the transom. 3. The large foredeck features a large double sun pad with integrated pillows and glass holders. 4. Tender garage can accommodate a tender up to 3.1m in length. 5. Even at anchor, the 5000 Sport Yacht has a sense of sweeping speed about her sheer line. 6. Optional seating and table can be incorporated into the forward port side of the cockpit under the weather protection of the cabin roof overhang and sun awning.





ENGINEERED FOR YOUR PLEASURE

The 5000 Sport Yacht is above else a robust, reliable and brilliantly engineered vessel. It is a boat in which you can have supreme confidence.

The propulsion system offers easy manoeuvring in close quarters such as marinas as well as overall performance. Cummins Mercruiser Diesel claims up to 30 percent improved fuel economy as well as 15 percent faster cruise and top speeds over conventional drive units.

The underwater profile of the Riviera 5000 Sport Yacht includes two Zeus drive units with aft-facing counter-rotating propellers and underwater exhausts mounted in tunnels that protect the pod drives from underwater debris.

An advanced joystick control system for slow-speed manoeuvring can be operated with one hand and a single turn of the wrist; from sideways tracking to spinning on a pin, to precise speed control. Zeus also features Skyhook™, a system that will maintain the vessel on a fixed heading within a tight area – even in strong currents and windy conditions.

This stability is enhanced by having a large-capacity, mid-mounted fuel tank for extended range. This boat is made for serious voyages as well as playful day cruising.

The relentless pursuit of perfecting our craft is evident in so many details – for instance, small fibreglass components like hatches and the swim platform are made with a injection moulding process to create a stronger component with a better double-sided finish.

Our Sport Yachts reflect the solid character and stable ride of our world-famous Flybridge Convertibles. The 5000 Sport Yacht is as agile and exhilarating as it is sure and steady. It is a boat designed to give you the best of both worlds.

7 and 8. The near perfect boat design that ticks all the 'must have' boxes on your boating wish list. Exhilarating performance with pod drive economy and ease of handling. Large cockpit with good weather protection and integrated furniture on the same level as the saloon. An aft galley adjacent to the cockpit for relaxed entertaining. Wide walk around side decks, sun pad, large electric sunroof (standard) and tender garage with huge lowering swim platform capable of taking a PWC. You couldn't wish for more.





YOUR OPENING TO MORE ENJOYABLE ENTERTAINING

Open the saloon door, open up the large, polished, stainless steel-framed rear window and you have transformed the cockpit and saloon into one enormous area, ideal for relaxing, socialising and entertaining. It's all on one level too. Just to enhance the sense of light and space – and create a pleasant through breeze – the side windows in the saloon slide open and there is a huge, electrically operated sunroof above the helm station.

Locating the galley aft by the rear door not only allows you to cater to the saloon and cockpit with ease, but the chef is always involved with the party. It's a very substantial galley too, with everything from high-quality Amtico flooring in the saloon to a large pantry, convection microwave oven, ample storage space and an optional drawer dishwasher. The cabinetry is clean and modern in its design. This is accented by the solid surface benchtops and stainless steel sink.

The cockpit offers generous seating, a large table that converts to a sun lounge via electric table legs, an electric barbecue and a teak-laid swim platform that raises and lowers at the touch of a button – a feature that comes in particularly handy for launching the 3.1 metre tender that is neatly garaged out of sight and out of the elements.

For serious sunning, large cockpit steps, wide side decks and a hand rail lead to a delightful sun pad on the foredeck. If you are more inclined to escape the midday sun, the luxurious leather lounge in the reverse cycle air-conditioned saloon will be a welcome escape. Plug your iPod into the Bose Lifestyle system or watch a movie on the LCD TV – a screen that disappears on an electric lift when not in use.

One of the greatest pleasures must surely be sitting at the helm. The helm chair is electrically adjustable and, like the companion chair, clad in the finest leather; the console is ergonomically designed and the vast, curved windscreen presents you with sensational views... It all adds up to a delightful sense of confidence and control.





10



11



12

ACCOMMODATING YOUR PERSONAL PREFERENCES

We know how important it is that your boat reflects your tastes, so when it comes to furnishings and fabrics we offer a wide choice of colours and styles. Below deck we go even further with customising your boat by giving you the choice of three staterooms and two bathrooms or two staterooms, two bathrooms, plus a second, more intimate lounge.

With the first option you have comfortable accommodation for seven. The alternate configuration provides you with another entertainment area below, perfect if you have children or grandchildren. Alternatively, it provides a welcome parents' retreat.

The Master Stateroom is spacious and bright and features a walk-around queen-size bed with innerspring mattress. Under-bed storage (easily accessible by virtue of gas struts), overhead cabinets and other storage and cedar lined hanging lockers accommodate everything you need for extended voyages.

Aft is the full beam VIP guest cabin that is also extremely comfortable and well laid-out with a double and single bed – and little touches like the cedar lining in the hanging lockers tell of the attention to detail that has gone into this design.

To starboard a further guest cabin features two pullman berths.

The 5000 Sport Yacht benefits from our advanced robotic varnishing facility. The gloss timberwork found both above and below deck has an utterly smooth, mirror-like finish.

Our commitment to quality design, materials and workmanship is also evident in the ensuite and second bathroom. Here you'll find Amtico flooring, solid-surface bench tops, elegant glass-bowl basins, the best mixer taps and showerheads and frameless doors to the shower stalls.

9. The lounge/dining area the full length of the port side of the saloon and features an adjustable and folding 10. The fully equipped galley features a convection microwave, two burner hot plates, two drawer fridges, large sink and (optional) drawer dishwasher. 11. The dining table fully extended.

12. The ergonomic helm station features fully adjustable dual helm chairs. 13 and 14. The full beam aft cabin features a double bed to starboard, a single berth to port, opening port holes and generous port lights in the hull. The starboard guest cabin features two single pullman berths, an opening porthole and ample storage. 15. Master stateroom ensuite 16. Guest cabin bathroom 17. Master stateroom offers a pleasing palette of fine timbers, fabrics and finishes. Large portholes in the hull make this a very inviting space.



13



14



15



16



Riviera 5000 Sport Yacht with Zeus Specifications

Length Overall <small>(inc. swim platform & bow roller)</small>	16.69 metres	54' 9"
Lh to ISO8666*	15.46 metres	50' 9"
Beam <small>(inc. gunwale)</small>	4.76 metres	15' 7"
Maximum Draft <small>(inc. props)</small>	1.25 metres	4' 1"
Dry Weight** <small>(approx., depends on engines & options)</small>	18,500 kgs	40,800 lbs
Fuel Capacity***	2,300 litres	608 US gal.
Water Capacity***	750 litres	198 US gal.
Holding Tank Capacity***	151 litres	40 US gal.
Sleeping Capacity	6 persons	
Standard Engine		
Cummins QSC 8.3 Zeus	442 kw	600 hp

The Riviera Group Clarification of Specification

* Length of the hull (Lh) to ISO8666: Includes all structural and integral parts. (ie. the moulded length of the hull.). It excludes parts that can be removed in a non-destructive manner without affecting the structural integrity of the craft, eg. pulpits, outriggers, diving platforms, rubbing strakes.

** Dry weight represents the estimated minimum weight of a boat with standard engines and options, no fuel or water on board, no equipment or provisions and no personnel. The stated dry weight may be exceeded.

*** Denotes nett tank capacity. For usable capacity do not rely on more than 90% of tank capacity. Actual usable capacity will vary according to boat trim and sea state.

Speeds are subject to normal weather conditions, fuel and/or water levels, passengers and equipment loads.

Refer to your Riviera Owner's Manual and your Dealer for height to hardtop and maximum height details.

The specifications in this document are not complete or definitive and are subject to change without notice and therefore may not be current. Riviera Marine (INT) Pty Ltd will not be liable (in contract, tort or otherwise) for any loss resulting from the inaccuracy of any information contained in this document.

Specifications may vary on a regional basis. Some images in this brochure may include non-standard or after-market options.

Warnings

The Riviera Group is committed to building the best luxury cruisers, tailored to suit specific countries and their individual compliance laws and regulations. Riviera equipment and build specifications approved for one country may not be compliant with another country's safety and equipment regulations and as such those cruisers may have no recourse to The Riviera Group's extensive manufacturer's warranties.

Each country and state has different safety equipment standards. It is important that you ensure the requirements in your jurisdiction are met prior to the vessel being used.

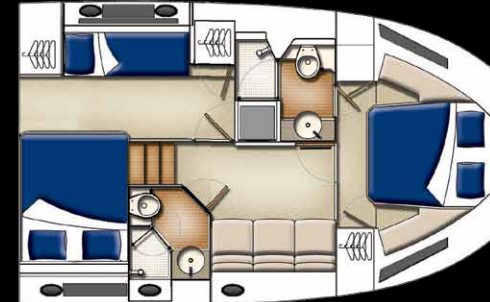
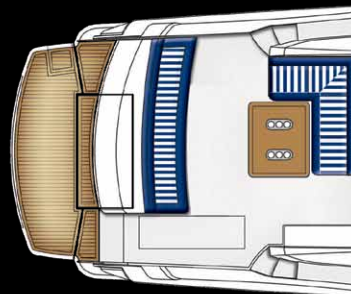
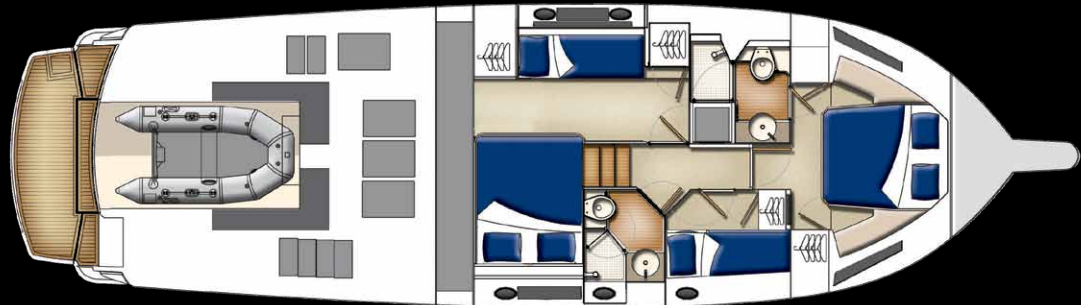
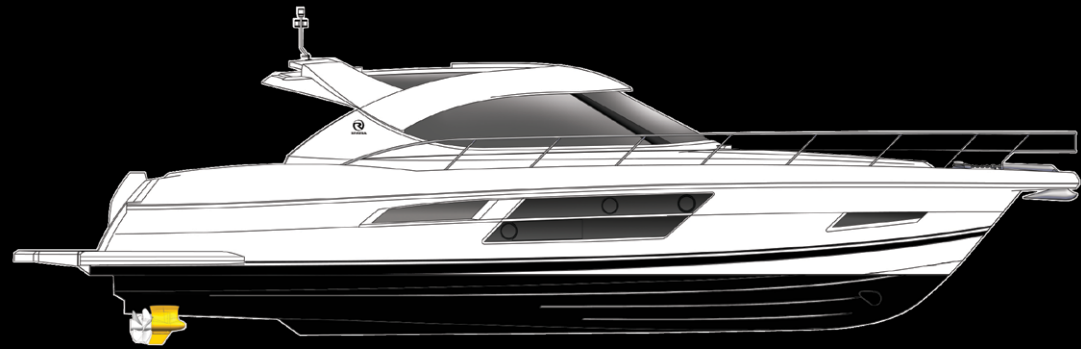

Optional Layout

Optional Layout



RIVIERA

www.rivieraaustralia.com

50169_5000SY_09/2012